



## ITAMI and KOBE to come alive with winter lights!

Kansai Airports Group is delighted to announce that Osaka International Airport (ITAMI) and Kobe Airport (KOBE) will be lit up again this winter. Both airports will employ uniquely designed lights to lift winter spirits. Enjoy heart-warming lights when you visit the airports! During the winter light period, the “Light It Blue” initiative will also remain in place, with the airports illuminated in blue in honor of healthcare workers.

Kansai Airports Group is committed to offering a new travel experience through exciting events for all its customers.

### Outline of Winter Lights

#### ITAMI



North terminal, Level 1



Concourse connecting north & south boarding gates

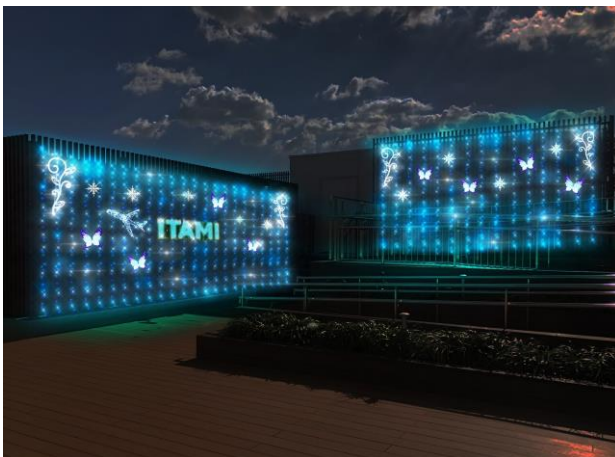

Observation deck (south)

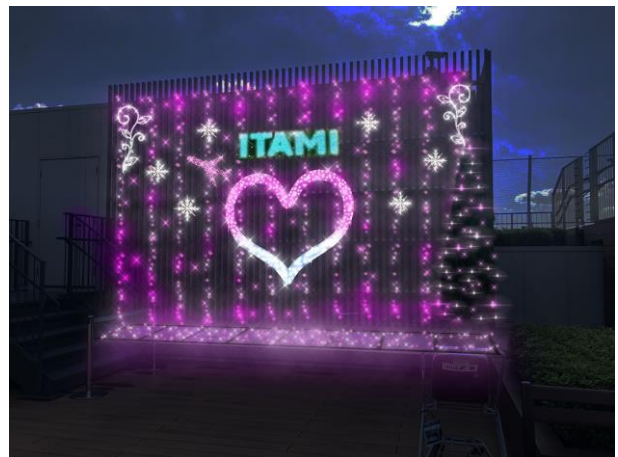

Observation deck (north)

**Location:** Observation deck; Level 1 of the north terminal (near group counter); and airside concourse (near boarding gates 13 & 14)

**Light-up period:**

Observation deck: Saturday, December 5 - Late February 2021, 6:00-21:30

Level 1 of north terminal: Saturday, December 5 - Late February 2021, 5:50-21:30

Airside concourse: Saturday, December 5 - Sunday, December 27, 5:50-21:30

**Details:** With “Golden Wish Winter” being the theme of the seasonal event, the winter lights will be lit up in hopes of bringing smiles and hopeful joy to everyone. The lights in elegant champagne gold will produce a bright, stunning atmosphere, sparkling to give a warm welcome to all visitors.

## **KOBE**



**Location:** Observation deck

**Light-up period:** Saturday, December 5, 2020 - Sunday, February 28, 2021, 16:00-22:00

**Details:** Going with the “Light It Blue” initiative, the seasonal lights will carry the theme of appreciation. The airport will show gratitude to everyone with the lights giving a warm glow and creating a visual treat for all its visitors.

\* Sadly, there will be no winter lights at Kansai International Airport this season as the observation deck remains closed due to the pandemic.

---

### **Contact Information**

Public Relations

Group Corporate Communications Department

TEL: +81-72-455-2201



Kansai Airports was established by a consortium made up of VINCI Airports and ORIX Corporation as its core members. Kansai Airports took over the operations of Kansai International Airport (“KIX”) and Osaka International Airport (“ITAMI”) from New Kansai International Airport Company (“NKIAC”) and has been operating the two airports since April 1, 2016.

Kansai Airports Kobe, Kansai Airports’ wholly-owned subsidiary, took over the operations of Kobe Airport (“KOBE”) from Kobe City and started its business as an operating company on April 1, 2018.

Under the concept of “One Kansai Airports Group”, Kansai Airports group strives to continuously improve its services for all airport guests through appropriate investments and efficient operations, with safety and security being the top priority. Kansai Airports group aims to maximize the potential of the three airports, for the benefit of the communities they serve.

For more information, please visit : <http://www.kansai-airports.co.jp/en/>

### Kansai Airports

Location	1-banchi, Senshu-kuko kita, Izumisano-shi, Osaka	Shareholders	ORIX 40%, VINCI Airports 40%, Other investors 20% <sup>1</sup>
Company Representatives	Representative Director and CEO:Yoshiyuki Yamaya Representative Director and Co-CEO: Benoit Rulleau		
Business Scope	Operation and management services, etc. of Kansai International Airport and Osaka International Airport		

### Kansai Airports Kobe

Location	1-ban, Kobe-kuko, Chuo-ku, Kobe-shi, Hyogo	Shareholder	Kansai Airports 100%
Company Representatives	Representative Director and CEO: Yoshiyuki Yamaya Representative Director and Co-CEO: Benoit Rulleau		
Business Scope	Operation and management services, etc. of Kobe Airport		



ORIX Corporation (TSE: 8591; NYSE: IX) is an opportunistic, diversified, innovation-driven global powerhouse with a proven track record of profitability. Established in 1964, ORIX at present operates a diverse portfolio of businesses in the operations, financial services, and investment spaces. ORIX’s highly complementary business activities span industries including: energy, private equity, infrastructure, automotive, ship and aircraft, real estate and retail financial services. ORIX has also spread its business globally by establishing locations in a total of 37 countries and regions across the world. Through its business activities, ORIX has long been committed to corporate citizenship and environmental sustainability. For more details, please visit our website:

<http://www.orix.co.jp/grp/en/>



VINCI Airports, as the leading private airport operator in the world, manages the development and operation of 45 airports located in Brazil, Cambodia, Chile, Costa Rica, the Dominican Republic, France, Japan, Portugal, Serbia, Sweden, the United Kingdom and the United States. Served by more than 250 airlines, VINCI Airports’ network handled 255 million passengers in 2019. Through its expertise as a comprehensive integrator, VINCI Airports develops, finances, builds and operates airports, leveraging its investment capability, international network and know-how to optimise the management and performance of airports and to carry out airport expansions and upgrades. In 2019, its annual revenue for managed activities amounted to €4.9 billion, for a consolidated revenue of €2.6 billion.

[www.vinci-airports.com](http://www.vinci-airports.com)

<sup>1</sup> ASICS Corporation; Iwatani Corporation; Osaka Gas Co., Ltd.; Obayashi Corporation; OMRON Corporation; The Kansai Electric Power Company, Incorporated; Kintetsu Group Holding Co., Ltd.; Keihan Holdings Co., Ltd.; Suntory Holdings Limited; JTB Corp.; Sekisui House, Ltd.; Daikin Industries, Ltd.; Daiwa House Industry Co., Ltd.; Takenaka Corporation; Nankai Electric Railway Co., Ltd.; NIPPON TELEGRAPH AND TELEPHONE WEST CORPORATION; Panasonic Corporation; Hankyu Hanshin Holdings, Inc.; Rengo Co., Ltd.; The Senshu Ikeda Bank, Ltd.; Kiyo Holdings, Inc.; The Bank of Kyoto, Ltd.; THE SHIGA BANK, LTD.; The Nanto Bank, Ltd.; Nippon Life Insurance Company; Mizuho Bank, Ltd.; Sumitomo Mitsui Trust Bank, Limited; MUFG Bank, Ltd.; Resona Bank, Limited; and the Private Finance Initiative Promotion Corporation of Japan.