



ITAMI Art Project to be rolled out throughout terminal

Kansai Airports is pleased to announce that various artworks will be displayed throughout the terminal building at Osaka International Airport (ITAMI) in conjunction with the airport's pre-opening scheduled for April 18, 2018 after renovation.

By involving the local community, the art program is designed to establish a distinct sense of place showcasing Kansai-centric artworks by professional artists as well as a collaborative art exhibition with local college and university students.

A participatory art event will also take place ahead of the pre-opening, aimed at getting local residents to participate in the painting of wall murals on the rooftop.

Kansai Airports is committed to building mutually beneficial relationships with local communities through artworks, while allowing airport guests to experience the unique sense of Kansai.

[Purpose]

The art project is intended to showcase Premium Kansai, our Sense of Place concept, through a variety of art exhibitions at ITAMI. In doing so, it also aims to make ITAMI an airport sharing harmonious and cooperative relationships with local residents.

[Overview]

- Distinctive artworks by professional artists featuring the Kansai region, displayed throughout the terminal building
 - Art painting event participated by locals
 - Exhibition of artworks by students studying art at colleges and universities in Kansai
- *Students' works will be displayed after April 2019.

<Participatory art event – Wall murals on the rooftop>

We will organize a participatory workshop where visitors will color the patterns sketched by a professional artist.

Date (five days): April 7 (Sat.), April 8 (Sun.), April 13 (Fri.), April 14 (Sat.), April 15 (Sun.)
Venue: Rooftop, Level 4, ITAMI

Sketch



When completed



Contact Information for Inquiries

Kansai Airports
Corporate Communication Dept.
TEL: +81-72-455-2212



As of April 1, 2016, Kansai Airports succeeded the operating rights of Kansai International Airport ("KIX") and Osaka International Airport ("ITAMI") from New Kansai International Airport Company ("NKIAC") and commenced business as an operating company for the two airports. Kansai Airports was established by a consortium made up of VINCI Airports and ORIX Corporation as its core members. Kansai Airports shares the common goal of maximizing the potential of the Kansai International Airport and Osaka International Airport, improving services to passengers and ensuring the highest levels of safety and security, investment to enhance safety, convenience and comfort to increase value, as well as enhancing community relations in the neighborhoods of the airports and benefiting the Kansai regional economy. On December 15, Kansai Airports signed a concession contract with the New Kansai International Airport Company ("NKIAC") for an operating period of 44-years. For more information, please visit : www.kansai-airports.co.jp/en/

Location	1-banchi, Senshu-kuko kita, Izumisano-shi, Osaka	Capital	25,000 million yen
Company Representatives	Representative Director and CEO: Yoshiyuki Yamaya Representative Director and Co-CEO: Emmanuel Menanteau	Date of Incorporation	December 1, 2015
Business Scope	Operation and management services, etc. of Kansai International Airport and Osaka International Airport	Shareholders	ORIX 40%, VINCI Airports 40%, Other investors 20% ¹



ORIX Corporation (TSE: 8591; NYSE: IX) is an opportunistic, diversified, innovation-driven global powerhouse with a proven track record of profitability. Established in 1964, ORIX at present operates a diverse portfolio of businesses in the operations, financial services, and investment spaces. ORIX's highly complementary business activities span industries including: energy, private equity, infrastructure, automotive, ship and aircraft, real estate and retail financial services. ORIX has also spread its business globally by establishing locations in a total of 37 countries and regions across the world. Through its business activities, ORIX has long been committed to corporate citizenship and environmental sustainability. For more details, please visit our website: <http://www.orix.co.jp/grp/en/>



VINCI Airports, a top 5 global player in the international airport sector, manages the development and operations of 35 airports located in France, Portugal (including the hub of Lisbon), Cambodia, Japan, Dominican Republic, Chile and Brazil. Served by more than 200 airlines, VINCI Airports' network handled 156.6 million passengers in 2017.

Through its expertise as a comprehensive integrator and the professionalism of its 12,000 employees, VINCI Airports develops, finances, builds and operates airports, leveraging its investment capability, international network and know-how to optimize the management and performance of existing airport infrastructure, facility extensions and new construction. In 2017, its annual revenue for managed activities amounted to €3.2 bn, for a consolidated revenue of €1.4 bn.

More comprehensive information is available on www.vinci-airports.com

¹ ASICS Corporation; Iwatani Corporation; Osaka Gas Co., Ltd.; Obayashi Corporation; OMRON Corporation; The Kansai Electric Power Company, Incorporated; Kintetsu Group Holding Co., Ltd.; Keihan Holdings Co., Ltd.; Suntory Holdings Limited; JTB Corp.; Sekisui House, Ltd.; Daikin Industries, Ltd.; Daiwa House Industry Co., Ltd.; Takenaka Corporation; Nankai Electric Railway Co., Ltd.; NIPPON TELEGRAPH AND TELEPHONE WEST CORPORATION; Panasonic Corporation; Hankyu Hanshin Holdings, Inc.; Rengo Co., Ltd.; The Senshu Ikeda Bank, Ltd.; Kiyo Holdings, Inc.; The Bank of Kyoto, Ltd.; THE SHIGA BANK, LTD.; The Nanto Bank, Ltd.; Nippon Life Insurance Company; Mizuho Bank, Ltd.; Sumitomo Mitsui Trust Bank, Limited; The Bank of Tokyo-Mitsubishi UFJ Ltd.; Resona Bank, Limited; and the Private Finance Initiative Promotion Corporation of Japan.

ITAMI Renovation

Exhibition of Artworks in the Terminal



Shaping a New Journey



**KANSAI
AIRPORTS**

ITAMI as a gateway to Sense of Place

- We want our airports to become a destination, not just transit locations
- We are committed to delivering a “Sense of Place” to our airports’ guests by bringing the Best of Japan and the Best of Kansai to KIX and ITAMI
- Various initiatives will be implemented in the renovated terminal building



Expression of Sense of Place through artworks

Purposes

- Express Sense of Place at ITAMI through art
- Build harmonious and cooperative relationships with local residents

We will exhibit 3 different types of artworks featuring Kansai:

- Artworks made by professional artists
- Collaborative artworks made by professional artists and local residents
- Artworks made by art students from local colleges around ITAMI (from April 2019)

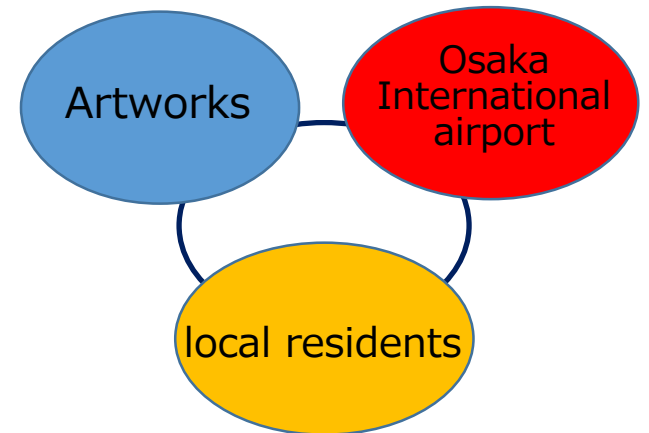

3. Overview of the artwork 1 F

Artist: Kenichi Shikata

- Born in Kyoto in 1983
- Graduated from Art and Architecture School of Waseda University.

EAST-WEST ART AWARD 2015, Grand Prize

The13th KAJIMA SCULPTUR COMPETITION, Silver Award

The art works

- 6 metal relief artworks
- Features mountains surrounding the Kansai region, which has a rich culture and beautiful natural environment. Its gentle curves represent the ridgeline of mountains, and the artwork reflects lights beautifully.

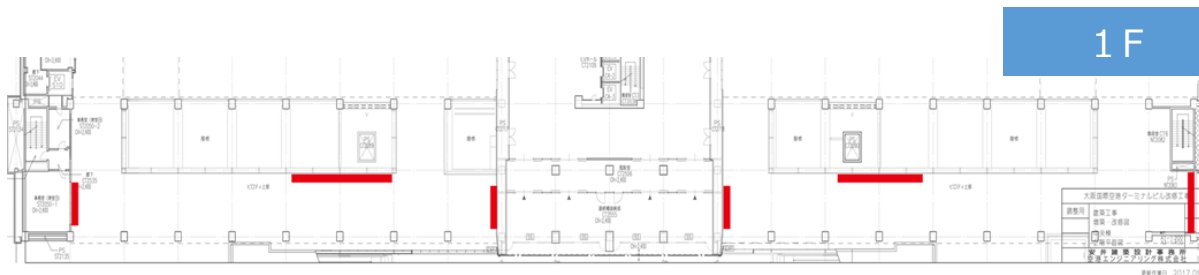

6 artworks displayed over 1F



Photo : Ayana Katayama



3. Overview of the artwork 2F-①

- **Artist:** Kineta Kunimatsu
Born in Hokkaido in 1977
Graduated from Tama Art University
The 24th DOGIN Cultural Foundation Art 2015,
Encouragement Award
- **Genre:** Wooden painting
- **Details:**
Kineta Kunimatsu boldly depicts the scenery
around ITAMI including Osaka Bay from the sky,
skillfully utilizing the texture of natural wood
grain of the board.
The bright color over the horizon represents
hope for the future.



© Kineta Kunimatsu

*Private Collection



3. Overview of the artwork 2F-②

- **Artist:** Sasaki AI
Born in Osaka in 1976
Graduated from Kanazawa College of Art
Solo Exhibition at Bernard Buffet Museum Shizuoka, 2014
Aichi Triennale, 2016
- **Genre:** Wall painting
- **Details:**
The painting depicts migrating birds flying over the local bamboo grasses as if they are planes or travelers departing from ITAMI. Carefully depicted beautiful shadows make the image of birds stand out.



Photo : Tadasu Yamamoto

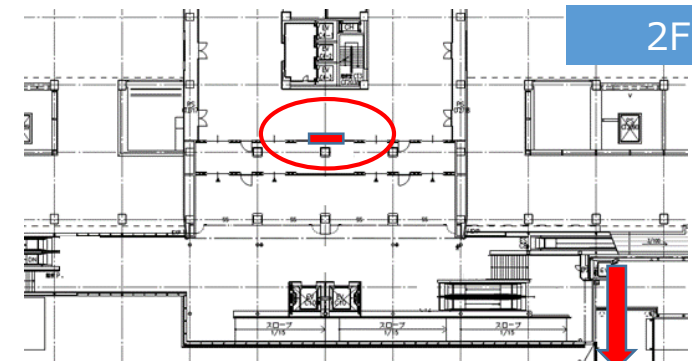

Station of monorail



3. Overview of the artwork 3 F

- **Artist:** Yuki Hayashi
Born in Kyoto in 1976
Started producing videos in 1997
Solo Exhibition at Hyogo Prefectural Museum of Art, 2011
- **Genre:** Digital art
- **Details:**
Animation created with hundreds of photos will be displayed on 16 digital screens. Visitors will enjoy various unusual sceneries of Kansai from these “windows”.



Photo : Omote Nobutada

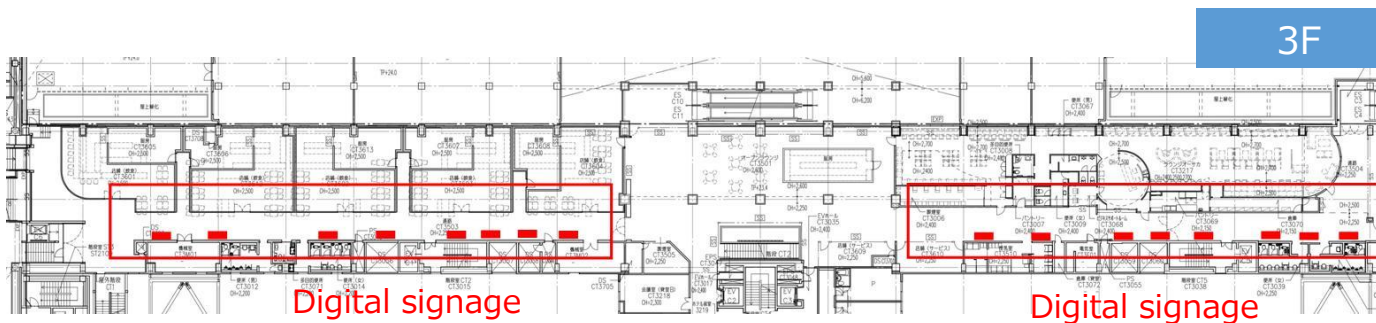

3. Overview of the artwork Rooftop

- **Artist:** BAKIBAKI

Born in Osaka in 1978, Graduated from Kyoto City University of Arts

WALL painting “BARTKIRA PARIS” GALERIE CORRAZZA 1787, 2017

Live-Painting at The Ritz-Carlton Kyoto, 2016

- **Genre:** Participatory wall painting

- **Details:**

Local visitors will color the unique and dynamic pattern outline sketched by BAKIBAKI.

The participants will render Kansai with many colors in their own ways.



BAKIBAKI

