



KIX to open 24-hour Café Lounge

- Lawn area and other space offering a moment of comfort to visitors -

Kansai Airports is excited to announce the opening of KIX Airport Café Lounge *NODOKA* in Aeroplaza at Kansai International Airport (KIX) on April 30, 2021.

Designed under the concept of "a cozy place like a tree branch for perching birds", the light-filled lounge in natural color offers calm and relaxing space for all users.

Operating 24/7, the lounge has a variety of seating options which cater to the diverse needs of airport visitors, such as enjoying a pre-boarding coffee break, working on a computer during a business trip, taking a quick nap when traveling on a red-eye or early morning flight, and refreshing themselves with a shower before or after a flight. The lawn space is perfect for customers who want to stretch out and relax, including those with small children.

Kansai Airports will continue to boost convenience and improve services to provide comfortable and exciting travel experiences for airport guests.

Name	KIX Airport Café Lounge <i>NODOKA</i>
Launch date	Friday, April 30, 2021 at 10:00 am
Location	Second floor of Aeroplaza
Operating hours	24 hours * The operating hours will be from 7:00 am to 8:00 pm while the COVID-19 state of emergency are in place in Osaka.
Facilities	<ul style="list-style-type: none"> - Walk-in lounge (Open to all guests) - Card members lounge (Free of charge for two hours for customers flying on the day of the lounge use and presenting a gold card or a higher-level card issued by any of the following partner credit card companies: VJA Group, Diners Club, JCB, NICOS, DC, UFJ, UC, TS CUBIC, Orico, Rakuten Card, and Aplus) - Dedicated seats for KIX-ITM Card premium members - Male and female shower rooms
Seating options	Open space, lawn space (artificial grass), private booths with mattress flooring or a reclining seat, group rooms, meeting room
Services	Free: Soft drinks, newspapers, magazines, Wi-Fi Paid: Alcoholic beverages, snacks, photocopier * Customers are allowed to bring their own food and drink. Alcoholic beverages will not be served during the state of emergency.
Fees	Open space: 550 yen for initial 30 minutes Private space: 660 yen for initial 30 minutes Shower: 660 yen for 40 minutes



Entrance

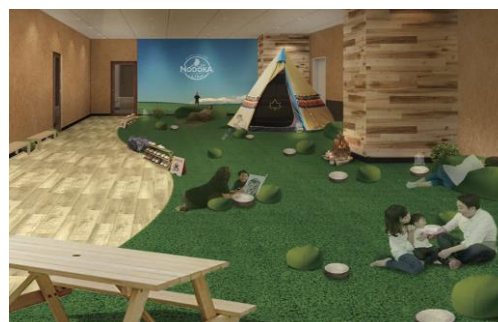

Lawn space

*For illustration purposes only

Contact Information

Public Relations

Group Corporate Communications Department

TEL: +81-72-455-2201

Shaping a New Journey



Kansai Airports was established by a consortium made up of VINCI Airports and ORIX Corporation as its core members. Kansai Airports took over the operations of Kansai International Airport (“KIX”) and Osaka International Airport (“ITAMI”) from New Kansai International Airport Company (“NKIAC”) and has been operating the two airports since April 1, 2016.

Kansai Airports Kobe, Kansai Airports’ wholly-owned subsidiary, took over the operations of Kobe Airport (“KOBÉ”) from Kobe City and started its business as an operating company on April 1, 2018.

Under the concept of “One Kansai Airports Group”, Kansai Airports group strives to continuously improve its services for all airport guests through appropriate investments and efficient operations, with safety and security being the top priority. Kansai Airports group aims to maximize the potential of the three airports, for the benefit of the communities they serve.

For more information, please visit : <http://www.kansai-airports.co.jp/en/>

Kansai Airports

Location	1-banchi, Senshu-kuko kita, Izumisano-shi, Osaka	Shareholders	ORIX 40%, VINCI Airports 40%, Other investors 20% ¹
Company Representatives	Representative Director and CEO:Yoshiyuki Yamaya Representative Director and Co-CEO: Benoit Rulleau		
Business Scope	Operation and management services, etc. of Kansai International Airport and Osaka International Airport		

Kansai Airports Kobe

Location	1-ban, Kobe-kuko, Chuo-ku, Kobe-shi, Hyogo	Shareholder	Kansai Airports 100%
Company Representatives	Representative Director and CEO: Yoshiyuki Yamaya Representative Director and Co-CEO: Benoit Rulleau		
Business Scope	Operation and management services, etc. of Kobe Airport		



ORIX Corporation (TSE: 8591; NYSE: IX) is an opportunistic, diversified, innovation-driven global powerhouse with a proven track record of profitability. Established in 1964, ORIX at present operates a diverse portfolio of businesses in the operations, financial services, and investment spaces. ORIX’s highly complementary business activities span industries including: energy, private equity, infrastructure, automotive, ship and aircraft, real estate and retail financial services. ORIX has also spread its business globally by establishing locations in a total of 37 countries and regions across the world. Through its business activities, ORIX has long been committed to corporate citizenship and environmental sustainability. For more details, please visit our website: <http://www.orix.co.jp/grp/en/>



VINCI Airports, the leading private airport operator in the world, manages 45 airports in 12 countries in Europe, Asia and the Americas. We harness our expertise as a comprehensive integrator to develop, finance, build and operate airports, while leveraging our investment capability and expertise in optimising operational performance, modernising infrastructure and driving environmental transition. VINCI Airports became the first airport operator to start rolling out an international environmental strategy, in 2016, with a view to achieving net zero emissions throughout its network by 2050.

www.vinci-airports.com

¹ ASICS Corporation; Iwatani Corporation; Osaka Gas Co., Ltd.; Obayashi Corporation; OMRON Corporation; The Kansai Electric Power Company, Incorporated; Kintetsu Group Holding Co., Ltd.; Keihan Holdings Co., Ltd.; Suntory Holdings Limited; JTB Corp.; Sekisui House, Ltd.; Daikin Industries, Ltd.; Daiwa House Industry Co., Ltd.; Takenaka Corporation; Nankai Electric Railway Co., Ltd.; NIPPON TELEGRAPH AND TELEPHONE WEST CORPORATION; Panasonic Corporation; Hankyu Hanshin Holdings, Inc.; Rengo Co., Ltd.; The Senshu Ikeda Bank, Ltd.; Kiyo Holdings, Inc.; The Bank of Kyoto, Ltd.; THE SHIGA BANK, LTD.; The Nanto Bank, Ltd.; Nippon Life Insurance Company; Mizuho Bank, Ltd.; Sumitomo Mitsui Trust Bank, Limited; MUFG Bank, Ltd.; Resona Bank, Limited; and the Private Finance Initiative Promotion Corporation of Japan.