

December 22, 2016

Kansai International Airport New Terminal 2 Opens on January 28

– Enhancing Traveler's Experience with Exciting Stores –

Kansai Airports announced that it will open the Terminal 2 International on January 28, 2017.

Throughout Terminal 2 a variety of services will be available including ATMs, foreign currency exchange, and traveler's insurance vending machines in addition to stores and restaurants.

The retail stores will feature walk-through style duty-free shopping for the first time at an airport in Japan. Large-scale shops featuring products popular with travelers such as cosmetics, confectioneries, electrical appliances, tobacco, and many others will be arranged along a main aisle to make it easier for customers to choose their favorite products. A number of specialty shops popular among Chinese customers such as drug stores and stores selling watches are also included.

Two restaurants featuring "Japanese" and "Kansai Area" specialty dishes are included in the new Terminal. A variety of restaurants feature a rich assortment of menu items which will cater for the great number of customers and travelers who visit and use the airport.

Terminal 2 will provide comfortable and convenient experiences through its variety of shops and services.

*The total floor space of shopping area (such as duty free, retail and food and beverage stores) is 1,640 square meters, in which walk-through style duty-free shopping area covers 1,090 square meters of floor space.

Terminal 2 Layout

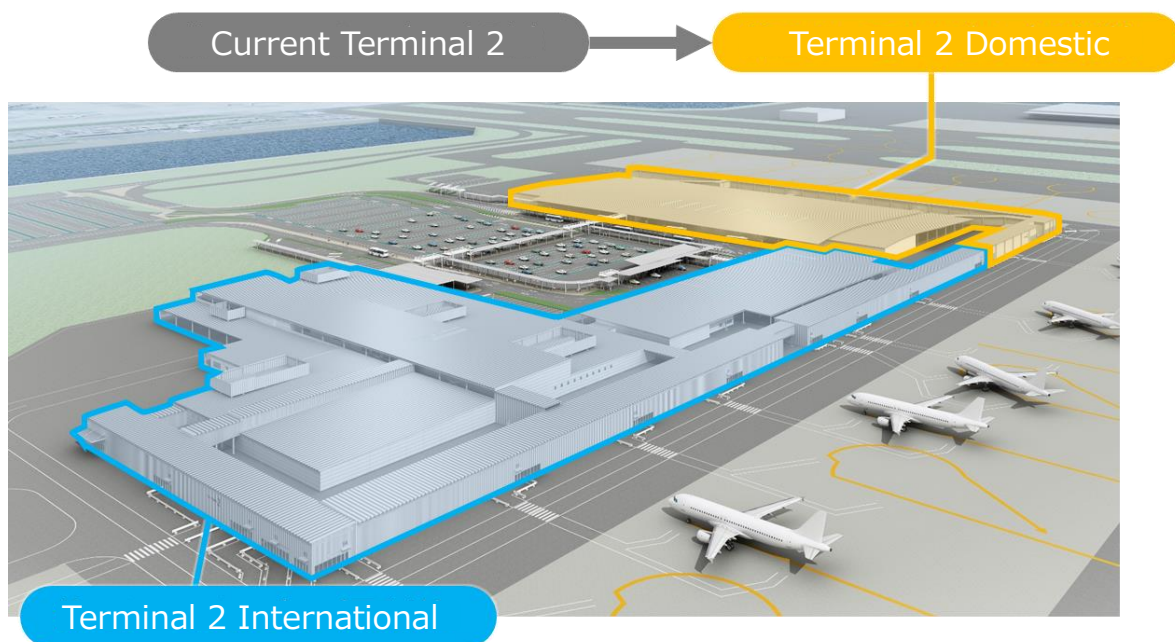

【Contact information for inquiries】

Kansai Airports Corporate Communication Dept.
tn0010@kansai-airports.co.jp TEL: +81-72-455-2212

Terminal 2 International MAP

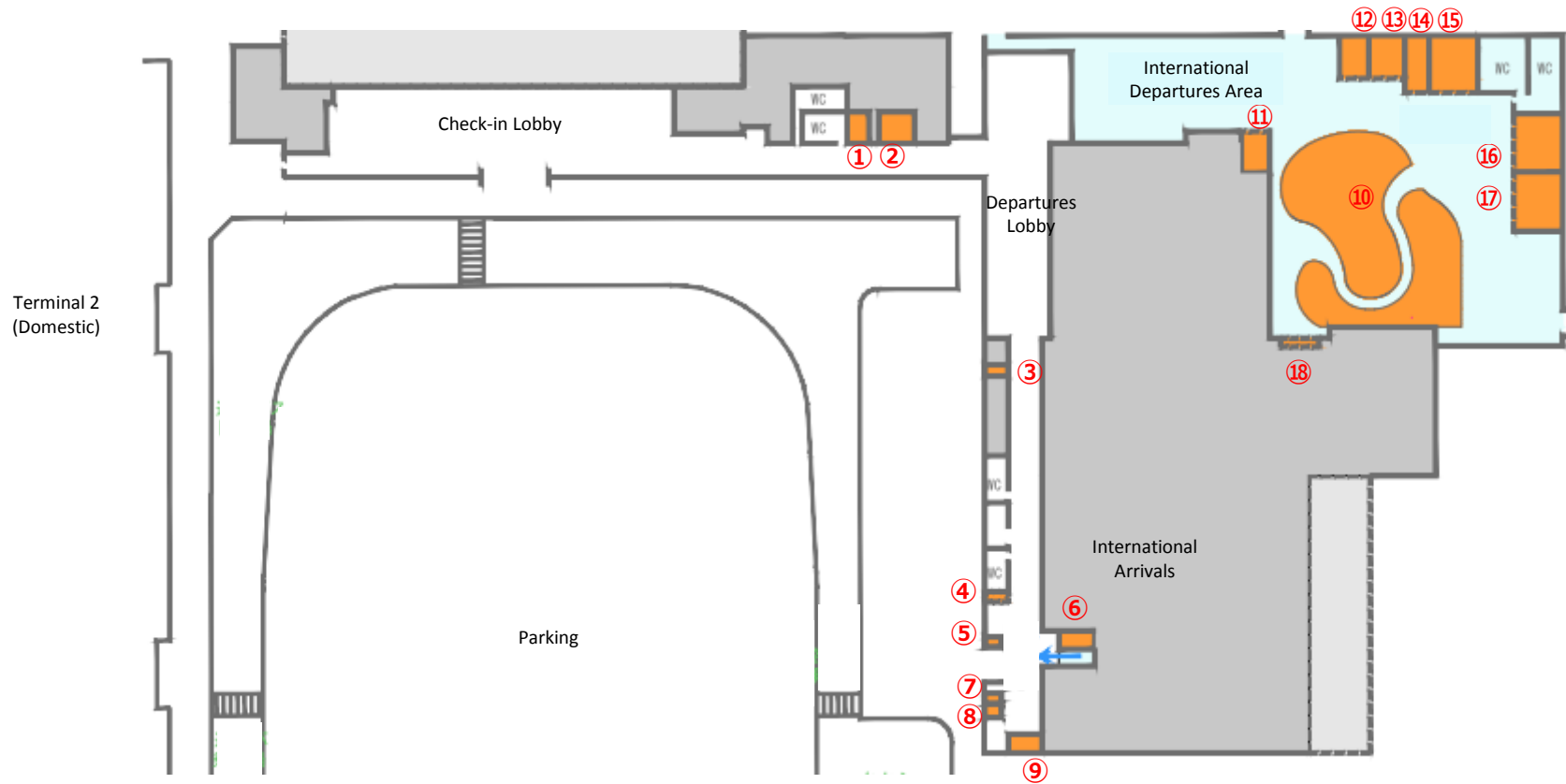

Numbers on the map match to the shop list on next page.

Terminal 2 International Shop List

Area	Classification	No.	Store Name	Business Category	Characteristic
Public Area	Service	①	XCom Global Kansai International Airport Terminal2 Departure Gate	Communication equipment rental	Communication equipment rental of WiFi routers and sales of SIM cards.
		⑧	XCom Global Kansai International Airport Terminal2 Arrival Gate	Communication equipment rental	Communication equipment rental of WiFi routers and sales of SIM cards.
		②	SMBC Kansai International Airport No.3 Foreign Exchange Counter	Currencyexchange	Provides currency exchange services.
		⑥	SMBC Kansai International Airport No.2 Foreign Exchange Counter	Currencyexchange	Provides currency exchange services and collect taxes.
		⑨	KANSAI TOURIST INFORMATION CENTER KANSAI INTERNATIONAL AIRPORT	TouristInformation	Offers tourist information about Japan including Kansai region in multiple languages. Sells subway passes for foreign tourists and tickets for transport facilities.
		④	Tourist information center Kanku Machidokoro	TouristInformation	Offers tourist information, hotels and transportation information in multiple languages. Also, sells and exhibits specialty goods from Izumi-Sano City.
		⑤	Spring Travel Japan	TouristInformation	Offers tourist information and sales point for Spring Airlines’ customers.
		⑦	Limousine bus information counter	Access	Provides information about options for KIX shuttle bus and other public buses.
		③	Automatic service terminal for international travel insurance	Int'ltravelinsurance	—
Int'l Area	Duty Free	⑩	KIX DUTY FREE T2	Duty free retail	The largest walk-through style duty-free shopping in KIX. Meet customer needs that change everyday by offering “one stop shopping” concept with sales of a variety of products including perfume cosmetics, alcohol, tobacco, snacks, general goods and electronics products in one shop.
		⑯	KIX DUTY FREE WATCHES	Watches	A watch specialty store that offers Swiss brands including Longines, RADO, TISSOT and MIDO as well as fashion and sports watches in addition to Japanese brands such as SEIKO CASIO and CITIZEN.
		⑮	Fuchsia by peach International Gate shop	Duty free retail	A “Sense of Peach” concept store offering products and interior images related to Peach. This unique duty-free shop provides customers with a variety of goods from Peach original products to beauty brands.
	Retail	⑰	Applause	Souvenirs etc.	A specialty sweet shop offering the most popular Japanese sweets such as “Shiroi- Koibito”, “Tokyo Banana” and “Lloyds” in addition to popular Japanese and western sweets available in Kansai.
		⑭	cocokarafine	Drug	A drug store that provides essential goods for foreign travels such as Medicine, supplements, cosmetics and travel goods as well as popular souvenirs for foreign travelers.
		⑪	Daily SKY	Kiosk	Provides essential goods for travel and items to relax on a flight, such as snacks, drinks, baggage, convenient goods, specialty and local souvenirs for customers to have comfortable trips.
	F&B	⑫	nana’s green tea	Café	Japanese style casual café showcasing modernly-arranged Japanese food culture mainly through matcha (traditional green tea) and rice. E.g. matcha Latte, matcha sweets and rice bowls topped with a variety of foods.
		⑬	Osaka Gochi Shokudou	Restaurant	This restaurant provides a variety of menus focused on Osaka specialties such as Takoyaki and Kushi Katsu, which change over time.
	Service	⑱	Automatic foreign currency exchanging machine	Currencyexchange	—
		⑱	SEVEN BANK ATM	ATM	—

Walk Through Image



Shop Images



Fuchsia by peach
International Gate Shop

KIX DUTY FREE
WATCHES





Applause

cocokarafine



Daily SKY

Restaurant Images

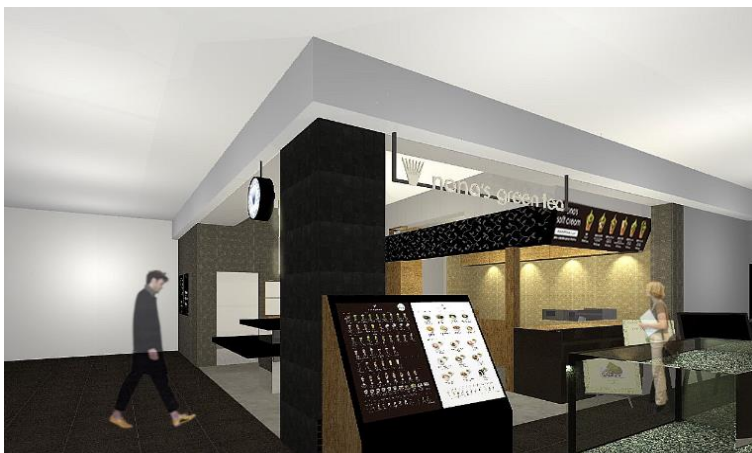

nana's green tea

Osaka Gochi Shokudo



About Kansai Airports

As of April 1, 2016, Kansai Airports succeeded the operating rights Kansai International Airport ("KIX") and Osaka International Airport ("ITM") from New Kansai International Airport Company ("NKIAC") and commenced business as an operating company for the two airports. Kansai Airports was established by a consortium made up of VINCI Airports and ORIX Corporation as its core members. Kansai Airports shares the common goal of maximizing the potential of the Kansai International Airport and Osaka International Airport, improving services to passengers and ensuring the highest levels of safety and security, investment to enhance safety, convenience and comfort to increase value, as well as enhancing community relations in the neighborhoods of the airports and benefiting the Kansai regional economy. On December 15, Kansai Airports signed a concession contract with the New Kansai International Airport Company ("NKIAC") for an operating period of 44-years. For more information, please visit: www.kansai-airports.co.jp/en/

Location	1-banchi, Senshu-kuko kita, Izumisano-shi, Osaka	Capital	25,000 million yen
Company representatives	Representative Director and CEO: Yoshiyuki Yamaya Representative Director and Co-CEO: Emmanuel Menanteau	Date of incorporation	December 1, 2015
Business scope	Operation and management services, etc. of Kansai International Airport and Osaka International Airport	Shareholders	ORIX 40%, VINCI Airports 40%, Others investors 20% ¹



ORIX Corporation (TSE: 8591; NYSE: IX) is an opportunistic, diversified, innovation-driven global powerhouse with a proven track record of profitability. Established in 1964, ORIX at present operates a diverse portfolio of businesses in the operations, financial services, and investment spaces. ORIX's highly complementary business activities span industries including: energy, private equity, infrastructure, automotive, ship and aircraft, real estate and retail financial services. ORIX has also spread its business globally by establishing locations in a total of 37 countries and regions across the world. Through its business activities, ORIX has long been committed to corporate citizenship and environmental sustainability. For more details, please visit our website: <http://www.orix.co.jp/grp/en/>



VINCI Airports, a top 5 global player in the international airport sector, manages the development and operations of 35 airports: 13 in France, 10 in Portugal (including the hub of Lisbon), 3 in Cambodia, 2 in Japan, 6 in Dominican Republic and Santiago airport in Chile. Served by more than 170 airlines, VINCI Airports' network handles more than 130 million passengers annually. Through its expertise as a comprehensive integrator and the professionalism of its 10,600 employees, VINCI Airports develops, finances, builds and operates airports, leveraging its investment capability, international network and know-how, to optimize management and performance of existing airport infrastructure, facility extensions and new construction. More comprehensive information is available on www.vinci-airports.com

¹ ASICS Corporation; Iwatani Corporation; Osaka Gas Co., Ltd.; Obayashi Corporation; OMRON Corporation; The Kansai Electric Power Company, Incorporated; Kintetsu Group Holding Co., Ltd.; Keihan Holdings Co., Ltd.; Suntory Holdings Limited; JTB Corp.; Sekisui House, Ltd.; Daikin Industries, Ltd.; Daiwa House Industry Co., Ltd.; Takenaka Corporation; Nankai Electric Railway Co., Ltd.; NIPPON TELEGRAPH AND TELEPHONE WEST CORPORATION; Panasonic Corporation; Hankyu Hanshin Holdings, Inc.; Rengo Co., Ltd.; The Senshu Ikeda Bank, Ltd.; Kiyo Holdings, Inc.; The Bank of Kyoto, Ltd.; THE SHIGA BANK, LTD.; The Nanto Bank, Ltd.; Nippon Life Insurance Company; Mizuho Bank, Ltd.; Sumitomo Mitsui Trust Bank, Limited; The Bank of Tokyo-Mitsubishi UFJ Ltd.; Resona Bank, Limited; and the Private Finance Initiative Promotion Corporation of Japan.